

10
YEARS
WARRANTY

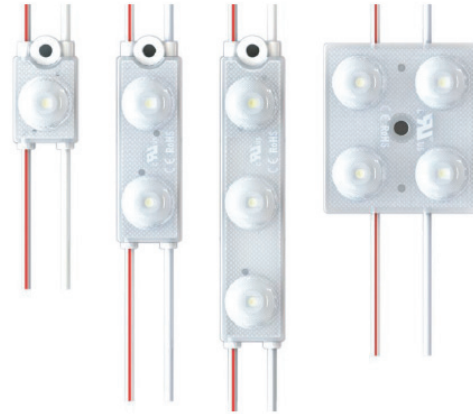

LED MODULES

SA M-NV 12V Series

Features

- Premium LED module series with 10 Years Warranty.
- High Efficiency (170lm/w) ✨ : Low power consumption and high brightness
- Best suited for lightboxes or letters with depths ranging from 50mm more
- Constant Current
- 175° Wide beam angle

Specification

Type	Item Code	Power(W)	Current(A)	CCT	Luminous Flux(lm)
1 LEDs	SA 2191	0.36W	0.03A	6500K	61 lm
2 LEDs	SA 2291	0.72W	0.06A	6500K	123 lm
3 LEDs	SA 2392	1.08W	0.09A	3000K	185 lm
	SA 2392-A			4000K	
	SA 2392-B			5000K	
	SA 2391			6500K	
	SA 2393			10000K	
	SA 2394			RED	
	SA 2395			BLUE	
SA 2396	GREEN				
4 LEDs	SA 2491	1.44W	0.12A	6500K	245 lm
4 LEDs	SA 24C1	2W	0.166A	6500K	310-330 lm

Certification



Warranty

Warranty	10 Years
----------	----------



PREMIUM LED

**Lighting
the way with
Confidence**

M-NV Series

Premium Quality Warranty,
but to last and to be
supported by a 10-Year.



**GET
A FREE
LED
LAYOUT**

Send Artwork Files To

service@sa-led.com

What's included?

- ✓ The best modules and quantities.
- ✓ Module pitch for even brightness.
- ✓ Suggest the best power supplies.

Technical Characteristics

Voltage	DC 12V
Efficiency	up to 170lm/W
IP Rating	IP67
View Angle	175°
CRI(Ra)	up to RA>80

Temperature Ranges

Operating temperature	-25~60°
Storage temperature	-40~85°

| Luminous intensity distribution diagram

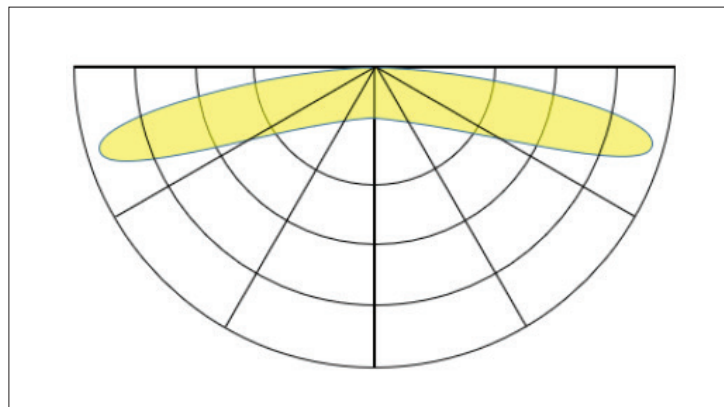

Beam angle: 175°

Physical Characteristics

Profile Drawings

1 LED

Weight : 10g

C to C: 100mm

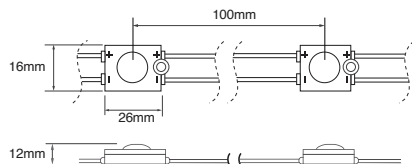

2 LED

Weight : 10g

C to C: 150mm

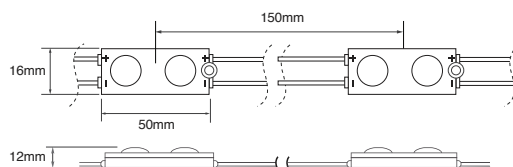

3 LED

Weight : 16g

C to C: 220mm

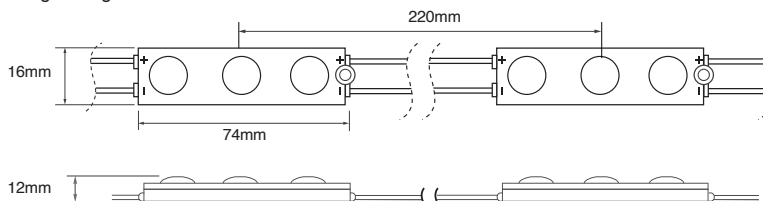

4 LED

Weight : 16g

C to C: 320mm (SA 2491 : 260mm)

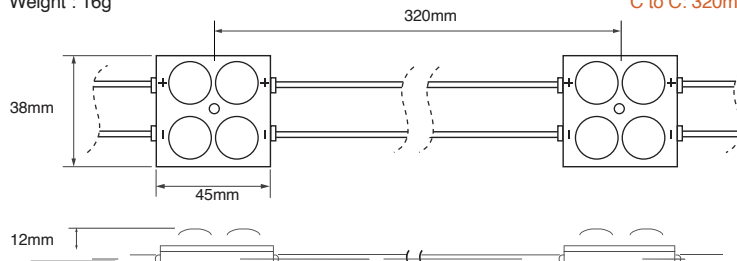

4 LED - Max in series 20 EA

*4 LED 12V (SA 24C1) ONLY

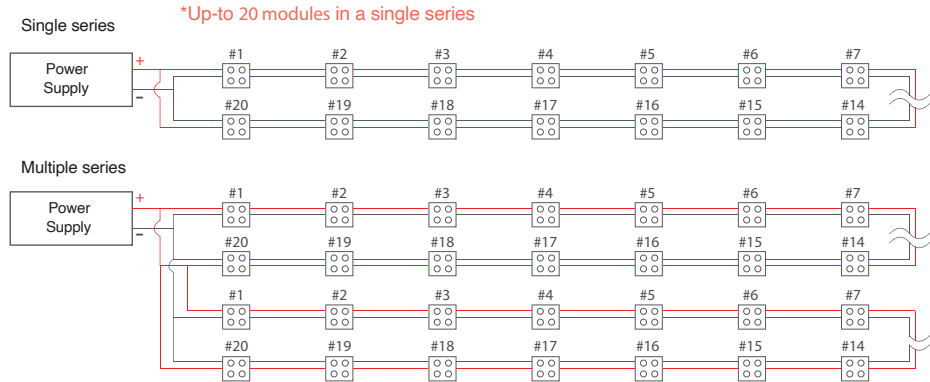

Max in series 50 EA

1LED / 2LED / 3LED / 4LED

